

**OILMIN**



# **Capability Statement**

A Modular Building System

# Ezy House

OILMIN is the exclusive distributor and agent for the Ezy-House Flat Packs in Papua New Guinea. Ezy-House offers a modular, and cost effective solution.

Ezy-House units are 'plug & play' installations that comply to Domestic (AS/NZ/PNG) and International Standards (ISO). They are shipped in flat-packed clusters of 20" ISO container sized bundles—certified for international shipping (CSC Plate).

- ✓ Modular System
- ✓ 20' ISO Container size
- ✓ Certified for international shipping
- ✓ Easy trucking
- ✓ Easy handling at site
- ✓ Cost effective & fast
- ✓ Flat packed in 'Kit Form'
- ✓ Fast & Easy Installation
- ✓ International standards
- ✓ Plug & Play
- ✓ Customizable Layouts



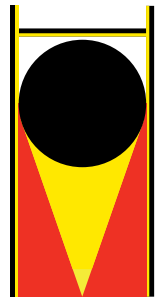

# Modular Building Blocks

- ✓ The standard design has been adapted to accommodate the unique conditions of PNG and can be further customized to meet specific standards (AS/NZS/PNG).
- ✓ The units are designed as a multi-functional modular building system built to the highest International Standard.
- ✓ The Units can be connected in both longitudinal and transverse directions without limits and can be stacked two or three units high, creating different floors.
- ✓ The wainscots of the units are made of insulated panels and offer a pleasant climate in the interior due to their building and physical properties.
- ✓ The standard units are fitted with windows, external or internal doors, PVC rolling shutters and full electricity fittings according to various international standards and regulations, consisting of a distribution box, various power plugs, light switches and neon lights.
- ✓ Various Accessories available

## Assembly

- ✓ Flat-pack units must be installed on suitably supported foundations (Three points along the long side)
- ✓ Individual modules can be lifted by crane and moved into position
- ✓ Modules are coupled together by special brackets with “daisy chains” to run the electricity throughout the units.
- ✓ Walls can be added or removed as needed to accommodate the desired internal layout.
- ✓ Modules are certified for stacking up to three storeys
- ✓ Secondary roof sections can be added for additional rain protection, particularly in areas with tropical down pours. Add images of roof



# Basic Units

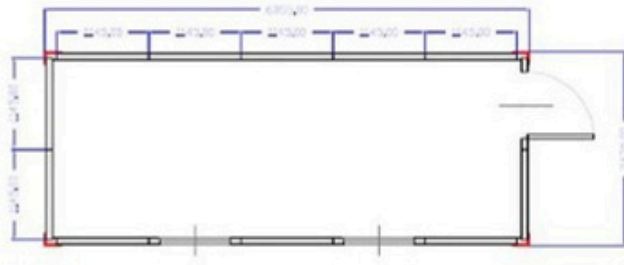

GENERAL LAYOUT (EH 101)

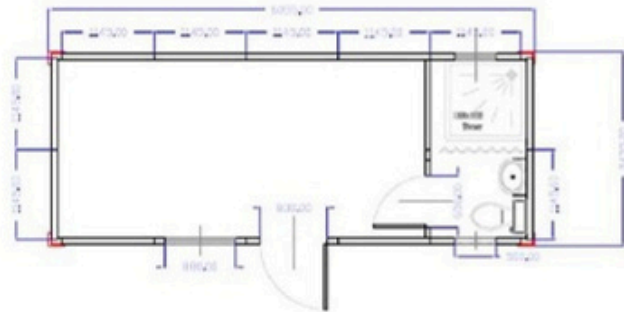

SINGLE UNIT LAYOUT (EH 114)

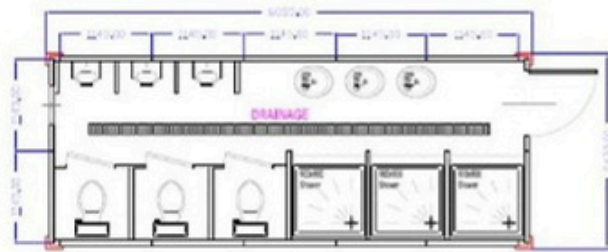
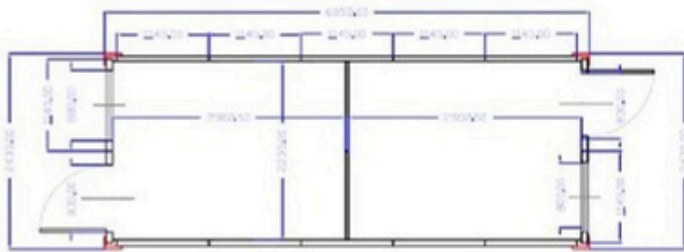

# Camp Projects



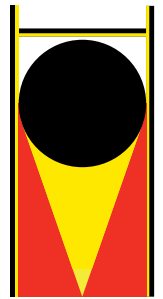

# 1-Man Sleeper (EH 114)

## Dimensions

6.05m (l) x 2.44m (w) x 2.79 (h), 14.75 sqm

- ✓ 1 x King-single bed, spring mattress
- ✓ 1 x desk with office chair
- ✓ 1 x 2-door wardrobe
- ✓ 1 x A/C unit (12,000 BTU)
- ✓ Sliding toilet door
- ✓ 1 x shower unit, hot & cold taps
- ✓ 1 x 55ltr hot water boiler
- ✓ 1 x hand wash basin, hot & cold taps
- ✓ 1 x toilet c/w toilet roll dispenser
- ✓ 1 x vanity mirror with small shelf
- ✓ 1 x towel rack
- ✓ 1 x single socket for wet area
- ✓ 1 x exhaust fan or small toilet window

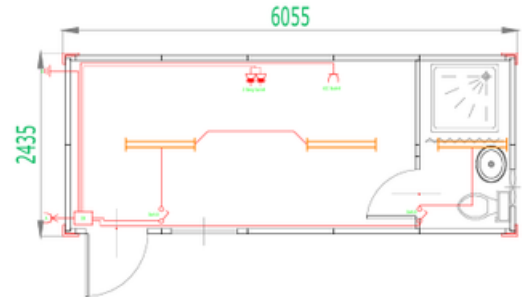

# 2-Men Sleeper (EH 104)

## Dimensions

6.05m (l) x 2.44m (w) x 2.79 (h), 14.75 sqm

- ✓ 2 x standard beds, spring mattress
- ✓ 2 x desk with office chair
- ✓ 2 x single door locker
- ✓ 2 x A/C units (12,000 BTU each)
- ✓ Common bathroom facilities in the block



## 4-Men Sleeper (EH 101)

### Dimensions

6.05m (l) x 2.44m (w) x 2.79 (h), 14.75 sqm

- ✓ 2 x bunk beds c/w drawer, spring mattress
- ✓ 1 x desk with chair
- ✓ 4 x single door lockers
- ✓ 1 x A/C unit (12,000 BTU)
- ✓ Common bathroom facilities in the block

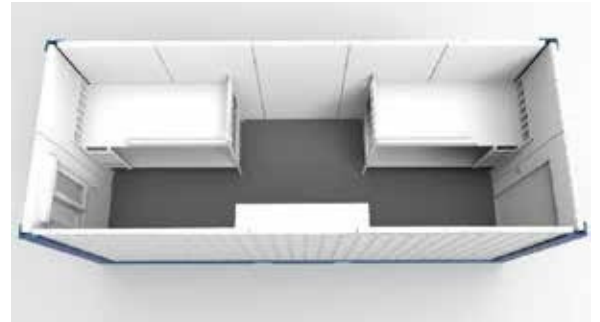
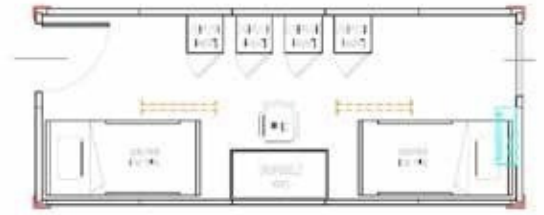

## Ablution Unit (AB102)

### Dimensions

6.055m (l) x 2.435 (w) x 2.79 (h)

- ✓ 3 x shower unit, hot & cold taps
- ✓ 2 x hand wash basin, hot & cold taps
- ✓ 3 x toilets c/w toilet roll dispenser
- ✓ 2 x Urinals c/w privacy partition
- ✓ 2 x vanity mirror with small shelf
- ✓ 2 x single socket for wet area
- ✓ 1 x exhaust fan or small toilet window
- ✓ A/C and Hot Water Boiler on request

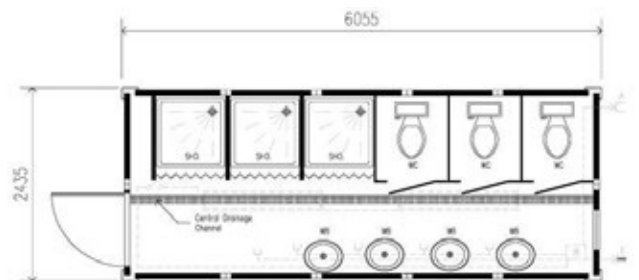

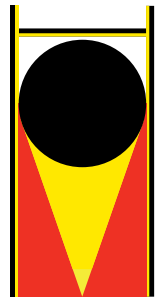



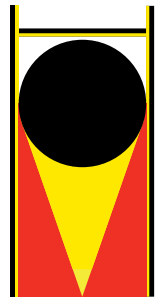

## Factory Shanghai



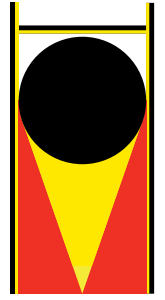

# Completed Projects



Construction Site Office



Workers Camp



Refugee Camp



Military Camp



Remote Drilling Camp



Pioneer Camp



VIP Accommodation Blocks



Accommodation Block



While the Factory caters to global production, PNG specific projects includes:

Project Reference where the Ezy-House™ has been used	Client
UK Army Camp Bastion Afghanistan	UK Royal Marines
PNG LNG Quarry Office	Wagners International
Accommodation South Africa	Foster Wheeler (Johannesburg)
Site Office	Exxon Mobil
PNG LNG Site Office	BAM / Clough
Zambia Accommodation Camp	Equinox Lumwana
PNG Herd Base Accommodation 96 people	InterOil Pty Ltd
PNG Port Moresby Site Office	Chicago Bridge Iron (CBI)
PNG Herd Base Training Centre	InterOil Pty Ltd
PNG LNG Site Office	Agility
PNG Airport Office	Deurgo Pte Ltd
AUS Procurement Office Brisbane	Exxon Mobil
PNG Hou Creek Camp Facilities 150-man Accommodation / Kitchen / Medical	InterOil Pty Ltd
PNG 250 Men Camp Stanley Gas Project	Horizon / Talisman Energy
PNG Office Structure in 2 Phases	PNG Government – Department of Works
PNG Kerema Doctors, Nurses Accommodation	PNG Government – Department of Health
PNG Kerema Kitchen & Mess Room for 300 PAX	PNG Government – Department of Health

The Factory's standard production rate is between 15 to 25 (maximum) units/day.



**OILMIN**

## OM HOLDINGS LTD

PO Box 8073 Boroko, 111 NCD,  
Papua New Guinea

### Physical Address

Lot 30, Sec 32 Ogoa Street  
Port Moresby  
Papua New Guinea

### Telephone

Port Moresby Office +675 3213153  
Mount Hagen Office +675 5421221

[www.oilmin.com](http://www.oilmin.com)